

**WESTWOOD
SCARIFIER**

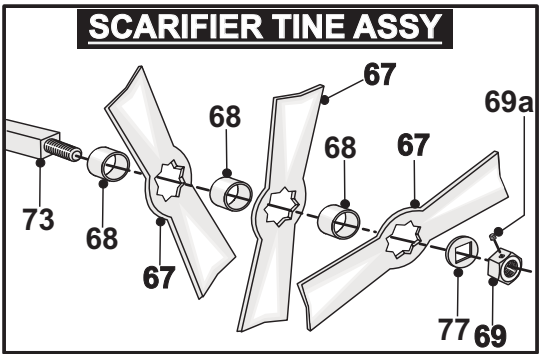
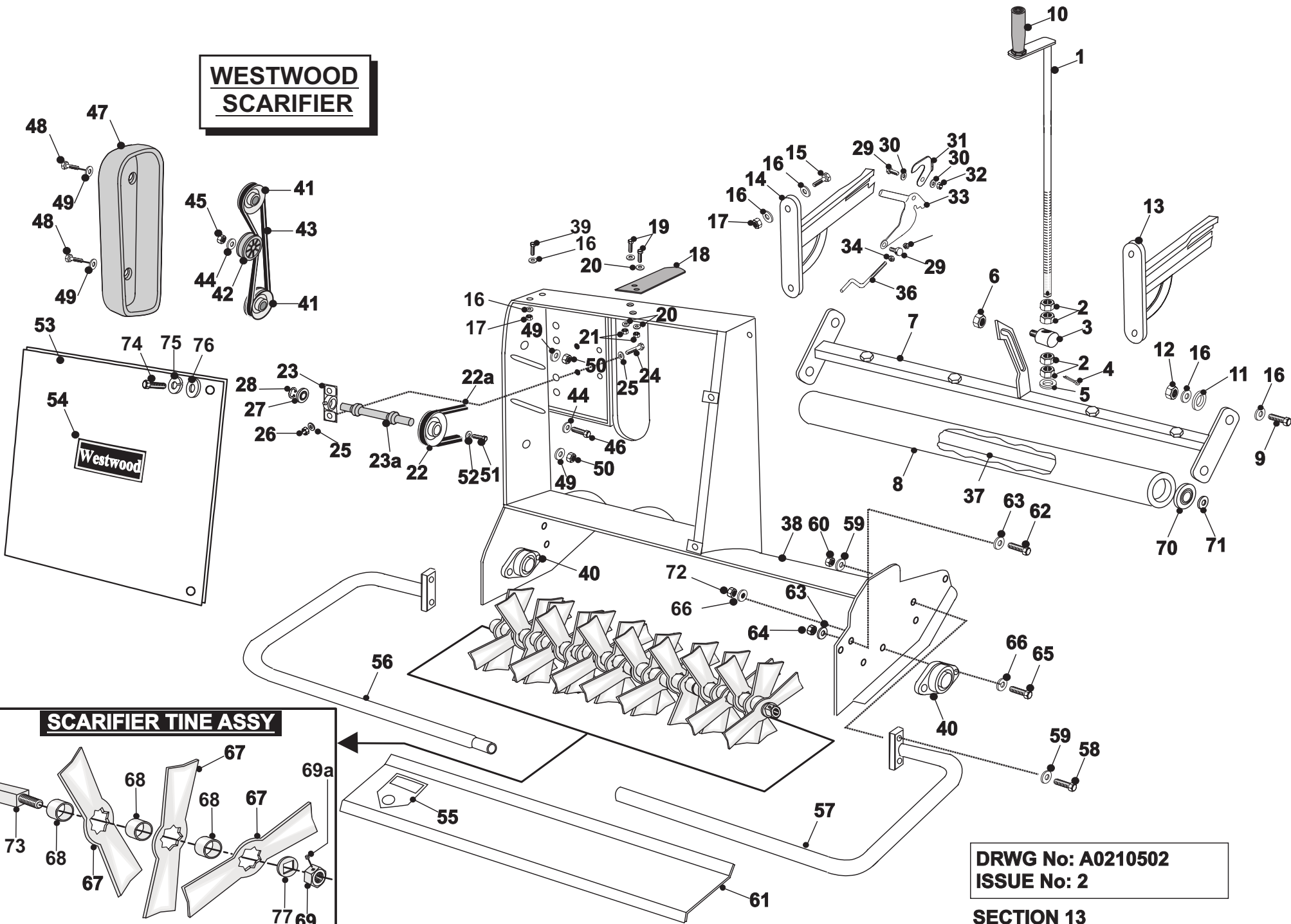

**DRWG No: A0210502
ISSUE No: 2**

SECTION 13

WESTWOOD SCARIFIER - PARTS LIST

	PART DESCRIPTION	PART NUMBER
1	Microset Adjustment Rod	318950900
2	Nut 12mm	049381200
3	Trunnion	18805500
4	Split Pin	06823300
5	Washer M12	089418500
6	Nyloc Nut M10	04886100
7	Roller Housing	327360100
8	Roller Tube	327002700
9	Bolt M8 x 30mm	018001600
10	Handle Adjustment Rod	148009500
11	Pivot Spacer	183023600
12	Nyloc Nut M8	04850600
13	Link Arm R/H)	327022500
14	Link Arm L/H	327022600
15	Bolt M8 x 25mm	01902300
16	Washer M8	088000200
17	Nyloc Nut M8	04850600
18	PTO Guard Retainer	301070000
19	Bolt M8 x 25mm	01902300
20	Washer M8	088001800
21	Nyloc Nut M8	04850600
22	Drive Pulley 3"	32727600
22a	Belt A55 Super 2 Dayco	228001100
	Belt A60 Super 2 Dayco (20/50 manual lift tractor)	228002100
23	Shaft Support Block	321123500
23a	Bearing Shaft	327023800
24	Bolt M10 x 40mm	019479100
25	Washer M10	088002400
26	Nyloc Nut M10	04886100
27	Bearing Shaft Support Block	108728100
28	Circlip Ext: M25	078000500
29	Bolt ¼" x 1" UNF	01844700
30	Washer ¼" T3 LP	08827800
31	Sweeper Locking Lug L/H	30149800
	Sweeper Locking Lug R/H	30150300
32	Nut 5/16" UNF Nyloc	04827500
33	Locking Lever L/H	27707701
	Locking Lever R/H	27707801
34	Nut ¼"	14938100
36	Adjustment Rod	313003500
37	Roller Shaft Internal	327023900
38	Body	327022700

MARCH 2005

COUNTAX SCARIFIER – PARTS LIST

39	Bolt M8 x 20mm	02825900
40	Column Lower Bearing	10801700
41	Pulley	20870800
42	Pulley	20811500
43	Belt A43 A & D Series	228001300
43	Belt A38 C Series only	22950300
44	Washer M8	088001800
45	Nut Nyloc M8	04850600
46	Bolt M8 x 50	018001800
47	Belt Guard	14849800
48	Bolt M8 x 70mm	01854800
49	Washer M8	088001800
50	Nut Nyloc M8	04850600
51	Bolt M8 x 16	018000500
52	Washer M8	088001800
53	Front Top Cover	303072200
54	Westwood Decal	9370
55	Decal `Blade Danger`	35803300
56	Safety Frame Guard L/H	301070100
57	Safety Frame Guard R/H	301070200
58	Screw M8 x 25mm	01902300
59	Washer M8	088001800
60	Nut Nyloc M8	04850600
61	Front Lower Cover	303072300
62	Screw M8 x 25mm	01902300
63	Washer M8	088001800
64	Nut Nyloc M8	04850600
65	Screw M12 x 40mm	028002100
66	Washer M12	089418500
67	Scarifying Tine	169381600
68	Spacer 23mm	183023700
69	Plain Nut 1" BSF Scarifier Shaft	049381700
69a	Grub Screw Scarifier Shaft Nut	028003800
70	Bearing 6203 3RS	10811600
71	Washer 5/16" T4 HP	08819500
72	Nut Nyloc M12	049381100
73	Shaft Scarifier Tines	321126000
74	Screw M6 x 16mm	019479200
75	Washer, Spring M6	089418400
76	Washer M6	088000300
77	Washer Scarifier Shaft (Squared Hole)	088004800

MARCH 2005